

## SAFE BATTERY USAGE

- Use alkaline batteries for best performance and longer life.
- Use only the battery type recommended for the unit.
- Batteries should be replaced only by an adult.
- Insert batteries with the correct polarity ( + and - ).
- Do not mix old and new batteries.
- Do not mix alkaline, standard (carbon-zinc), or rechargeable batteries.
- Do not short-circuit batteries.
- When not used for an extended time, remove batteries to prevent possible leakage and damage to the unit.
- Do not mix rechargeable and non-rechargeable batteries.
- Rechargeable batteries are to be removed from the toy before charging.
- Rechargeable batteries are to be recharged only under adult supervision.
- Do not recharge non-rechargeable batteries.
- Exhausted batteries are to be removed from the toy.
- Do not dispose of batteries in fire as they may leak or explode.

## FCC COMPLIANCE

NOTE: This equipment has been tested and found to comply with the limits for a Class B digital device, pursuant to Part 15 of the FCC Rules. These limits are designed to provide reasonable protection against harmful interference in a residential installation. This equipment generates, uses and can radiate radio frequency energy and, if not installed and used in accordance with the instructions, may cause harmful interference to radio communications. However, there is no guarantee that interference will not occur in a particular installation. If this equipment does cause harmful interference to radio or television reception, which can be determined by turning the equipment off and on, the user is encouraged to try to correct the interference by one or more of the following measures:

- Reorient or relocate the receiving antenna.
- Increase the separation between the equipment and receiver.
- Connect the equipment into an outlet on a circuit different from that to which the receiver is connected.
- Consult the dealer or an experienced radio/TV technician for help.

This device complies with Part 15 of the FCC Rules. Operation is subject to the following two conditions: (1) This device may not cause harmful interference, and (2) this device must accept any interference received, including interference that may cause undesired operation.

Caution: Modifications not authorized by the manufacturer may void users authority to operate this device. CAN ICES-3 (B)/NMB-3(B).



'Let's care for the environment!'  
The wheelee bin symbol indicates that the product must not be disposed of with other household waste. Please use designated collection points or recycling facilities when disposing of the item. Do not treat old batteries as household waste. Take them to a designated recycling facility.

Please keep this manual as it contains important information.  
Illustrations are for reference only. Styles may vary from actual contents.



0324-0-EINT  
Printed in China

www.LOLsurprise.com  
©2024 MGA Entertainment, Inc.  
L.O.L. SURPRISE TWEENS™ and COSTUME SURPRISE™ are trademarks of MGA in the U.S. and other countries. All logos, names, characters, likenesses, images, slogans, and packaging appearance are the property of MGA.

The preferred method of contact for Customer Service is through our e-mail contact form at [www.mgae.com](http://www.mgae.com)

- US/CA** - MGA Entertainment, Inc. 9220 Winnetka Ave, Chatsworth, CA 91311, U.S.A.  
Tel: +1 (800) 222-4685  
[www.mgae.com/contact](http://www.mgae.com/contact)
- UK** - MGA Entertainment UK Ltd. 50 Presley Way, Crownhill, Milton Keynes, MK8 0ES, Bucks, UK.  
MGA Consumer Services  
PO. Box 2040 Hockley, Essex, S55 4BF  
Tel: 0800 521 558  
E-mail: [ukconsumerservices@mgae.com](mailto:ukconsumerservices@mgae.com)
- EU** - MGA Entertainment (Netherlands) B.V. Baronie 68-70, 2404 XG, Alphen a/d Rijn, The Netherlands  
Tel: +31-172-758-010  
E-mail: [klantenservice@mgae.com](mailto:klantenservice@mgae.com)
- AU/NZ** - Imported by MGA Entertainment Australia Pty Ltd. Suite 5.05, 32 Delhi Road, Macquarie Park NSW 2113. AU.  
Tel: 1 300 059 676  
E-mail: [au-sales@mgae.com](mailto:au-sales@mgae.com)



SKUs: 504054/504139/504146 /510413



AGES 4+  
ADULT SUPERVISION REQUIRED

**WARNING:**  
CHOKING HAZARD-Small parts.  
Not for children under 3 years.

## CONTENTS

- A. 1 Fashion Doll
- B. 1 Head Accessory
- C. Fashion Outfit
- D. 1 Pair of Shoes
- (Ali Dance includes Leg Wraps)
- E. 1 Inflatable Pet with Base Inside
- F. 1 Doll Stand
- G. 1 C-Clip



EACH SOLD SEPERATELY

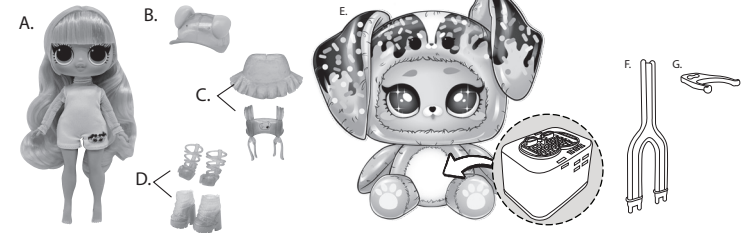

EACH SOLD SEPERATELY

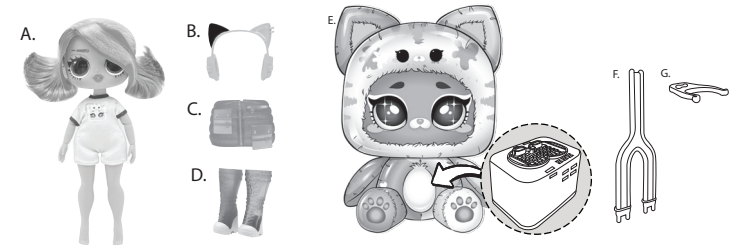

EACH SOLD SEPERATELY

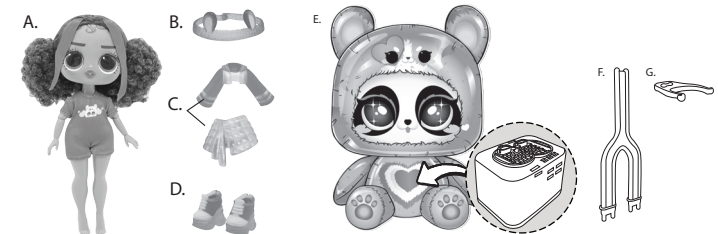

### TIPS:

- When removing the hands to dress doll, pinch the wrists' joints and gently pull. **DO NOT PULL FROM THE FINGERS.**

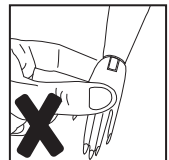
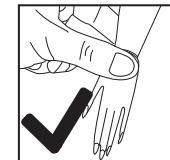

## REPLACING THE BATTERIES

The batteries included are for demonstration. It is recommended that, prior to playing, an adult install fresh alkaline batteries. Here's how:

1. Using a Phillips screwdriver (not included), remove the screw and battery compartment cover located inside the inflatable pet on the backside of the base.
2. Install four (4) fresh 1.5V AA (LR6) alkaline batteries (not included) making sure the (+) and (-) ends face the proper direction as indicated on the battery compartment cover.
3. Replace the compartment cover by inserting the tab on the side of the cover into the slot first and then press down on the cover and tighten the screw.

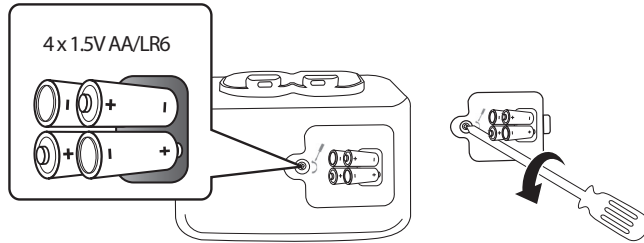

### ⚠ WARNING:

- Never throw any objects into the spinning motor.
- Keep long hair tied back and loose apparel away from the spinning motor.

## IMPORTANT INFORMATION

- To prevent batteries from dying, always switch the button to "off" after use.
- Do not leave contents in the sun or in very hot areas.
- Do not store the doll in direct sunlight for extended periods of time.
- Do not dry doll's hair with a hair dryer or subject hair to very high heat in any manner, as it will irreparably damage the hair.
- Remove the doll stand when not in use. If you wish to inflate the pet without the doll inside, please remove the doll stand to prevent possible injury.

## UNBOXING

- **PLASTIC TAGS AND BLISTER REMOVAL:** It is recommended that an adult carefully cut the plastic tags holding the blister in place: at the base of the doll stand; around the doll's waist; and behind the doll's head - see examples below (scissors not included); discard plastic tags and blister in a recyclable bin.

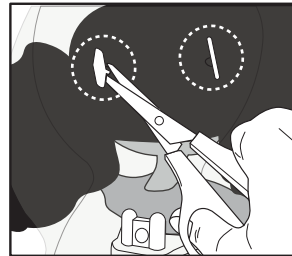
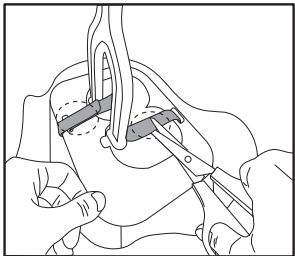

## KEYLOCK

1. Keylocks are located underneath the inflatable base. Turn counterclockwise to unlock.
2. Pull the keylock out and discard.
3. The inflatable base can now be easily removed from the packaging.

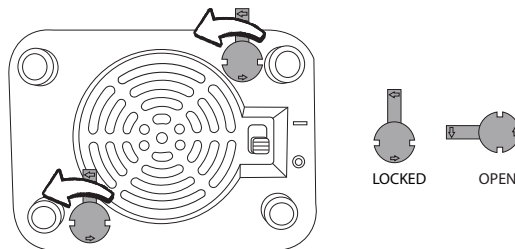

## DOLL STAND

Insert the doll stand with the tabs facing towards the back of the base (see step 2). You may damage the doll stand if you try inserting with the tabs facing forward. The doll may not be fully secure if the doll stand is not in place correctly.

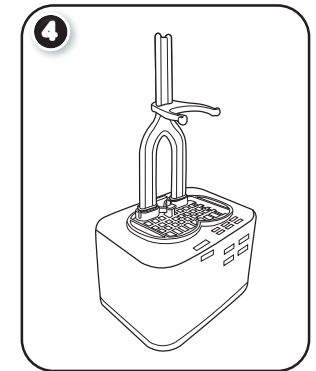
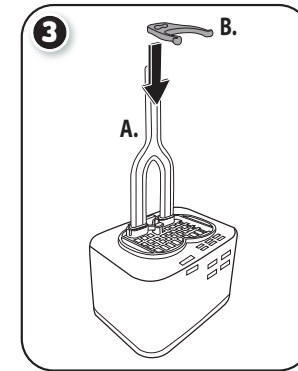
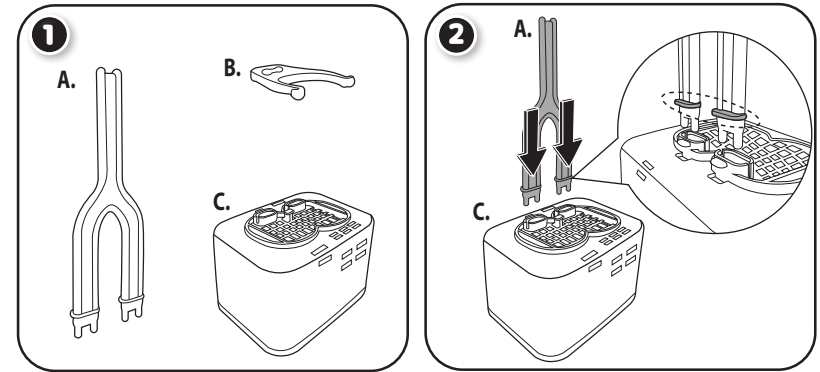

## INFLATING YOUR PET

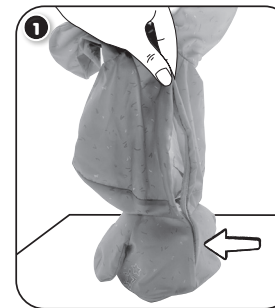

Ensure the fabric is closed as best as possible to contain the air inside all areas of the pet.  
**Pro Tip:** Hold the hook and loop fabric from the top and then begin closing the fabric from the bottom up.

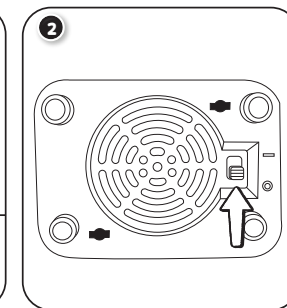

Flip the switch under the inflatable base from the "Off" to "On" position.

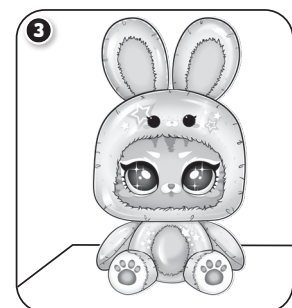

Watch your pet inflate!  
**Pro Tip:** Gently adjust the pet's ears or feet as needed.