



SLEEPOVER SURPRISE GAME



AGES
6+

558477

2-4 PLAYERS

CONTENTS

A. 200 L.O.L. Surprise!™ Challenge Cards B. 4 Sleepover Club Blindfolds C. 1 Game Board D. 1 Spinner

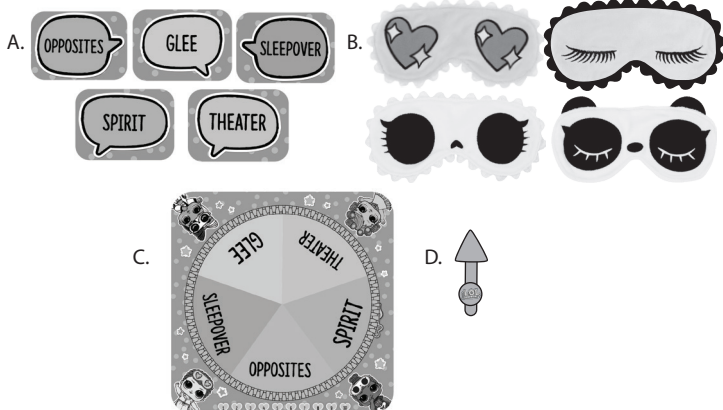

ASSEMBLY

1. Separate the spinner peg from the back of the spinner.
2. Place the spinner peg through the back of the game board.
3. Snap the spinner onto the spinner peg.

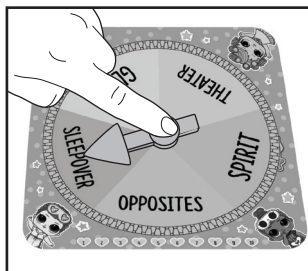
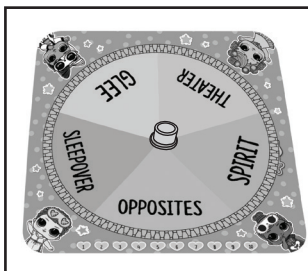
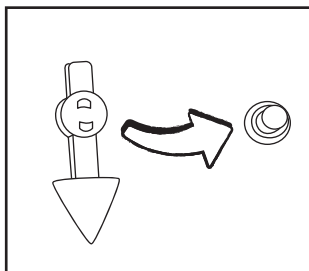

SET UP

1. Separate the challenge cards into piles by the club names on the back of the cards.
 - Opposites • Glee • Sleepover • Spirit • Theater
2. Shuffle the cards within each club.
3. Place the challenge cards in front of all players with the club name facing up.
4. Place the game board in the middle of all players.
5. Give each player a blindfold.



GAME PLAY

- **OBJECTIVE:** The game is played over 10 rounds. Keep track of the rounds using the round tracker on the side of the spinner. Use any household item to mark off the round. **After 10 rounds, players count the stars on the cards they earned. The player with the most stars is the winner!**
- **WHO GOES FIRST:** The player who lives at the home you're playing at goes first. If multiple players live there, the player with the next birthday goes first!

1 SPIN THE SPINNER AND PICK A CARD FROM THE MATCHING CLUB.

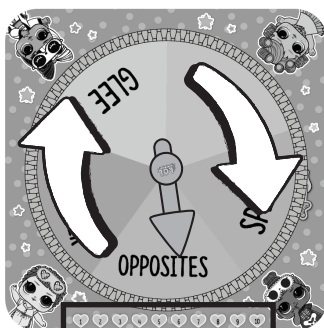

Keep track of the rounds!

2 DO THE CHALLENGE DESCRIBED ON THE CARD.

- Some challenges require you to use the included Sleepover Club blindfolds.
- After you complete a challenge, it's the next player's turn. Play in a clockwise motion.



3 PLAYER WITH THE MOST STARS AFTER 10 ROUNDS IS THE WINNER!

- Challenge cards have different star points.
- Keep the cards in front of you after you complete the challenge to easily keep track of your points.
- At the end of 10 rounds, count the total number of stars you have.

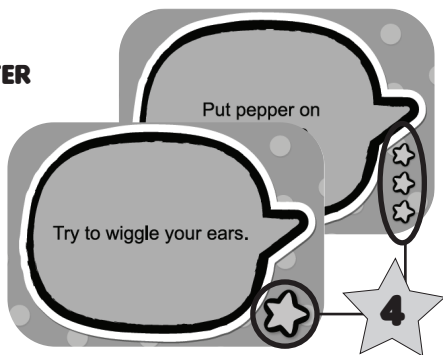

IMPORTANT INFORMATION

- Be careful of your surroundings when completing a challenge that requires the blindfold.
- Do not wear the blindfold around your neck while you are sleeping. Blindfold is for play purposes only.
- Illustrations are for reference only. Styles may vary from actual contents.

Please keep this manual as it contains important information.



0619-1-E/INT
Printed In China

www.LOLsurprise.com
©2019 MGA Entertainment, Inc.
L.O.L. SURPRISE!™ is a trademark of MGA in the U.S. and other countries.
All logos, names, characters, likenesses, images, slogans, and packaging appearance are the property of MGA.

MGA Entertainment
9220 Winnetka Ave, Chatsworth, CA 91311
U.S.A.
(800) 222-4685

MGA Entertainment UK Ltd.
50 Presley Way, Crownhill, Milton Keynes,
MK8 0ES, Bucks, UK
+ 0800 521 558

The preferred method of contact for Customer Service is through our e-mail contact form at www.mgae.com

MGA Entertainment (Netherlands) B.V.
Klipperaak 201, 2411 ND Bodegraven, NL
Tel.: +31 (0) 172-758 038
E-mail: klantenservice@mgae.com

Imported by MGA Entertainment Australia Pty Ltd
Suite 2.02, 32 Delhi Road
Macquarie Park NSW 2113
1300 059 676